

FLUKE®

T5-600/T5-1000

Electrical Tester

Instruction Card

⚠ Warning

- Read the T5-600/T5-1000 Safety Sheet before using this tester.
- Lisez la fiche de sécurité T5-600/T5-1000 avant d'utiliser cet appareil.
- Prima di usare questo tester leggere le istruzioni per la sicurezza allegate al T5-600/T5-1000.
- Vor Verwendung des Prüfgeräts das Sicherheitsblatt T5-600/T5-1000 lesen.
- Lea la hoja de instrucciones de seguridad T5-600/T5-1000 antes de utilizar este probador.
- Antes de usar este instrumento de teste, leia a Folha de Segurança T5-600/T5-1000.
- Lees voór gebruik van deze tester het veiligheidsblad bij de T5-600/T5-1000.
- Les sikkerhetsdataene for T5-600/T5-1000 før testinstrumentet tas i bruk.
- Man bør læse sikkerhedsanvisning T5-600/T5-1000 inden man benytter instrumentet.
- Lue T5-600/T5-1000 –turvaohjeet ennen tämän mittarin käyttöä.
- Läs säkerhetsdatabladet för T5-600/T5-1000 innan du använder denna testare.
- 本器を使用する前に、T5-600/T5-1000 Safety Sheet をお読みください。
- 이 테스터를 사용하기 전에 T5-600/T5-1000 안전 지침을

Voltage Indicator

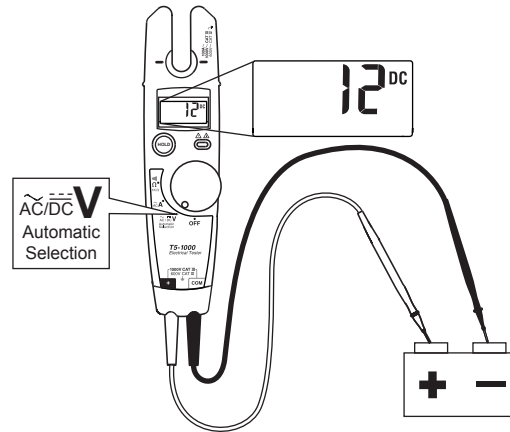
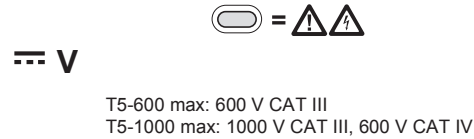

$\approx V$

45 Hz - 66 Hz
T5-600 max: 600 V rms CAT III
T5-1000 max: 1000 V rms CAT III, 600 V rms CAT IV

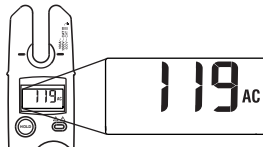

Continuity & Resistance Ω

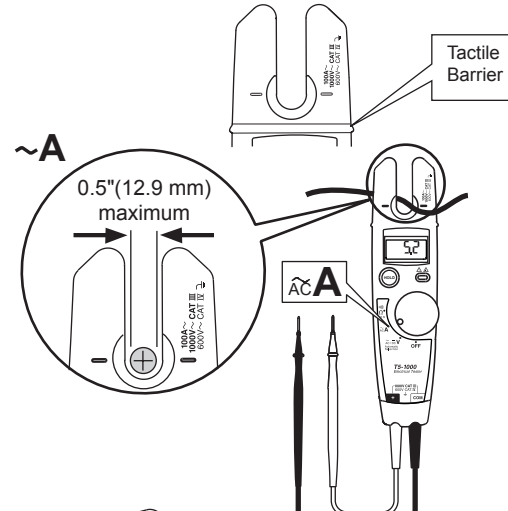
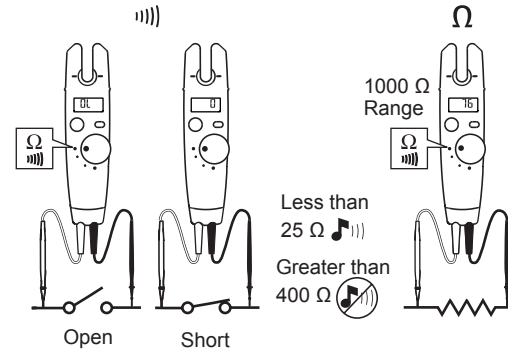

Display HOLD

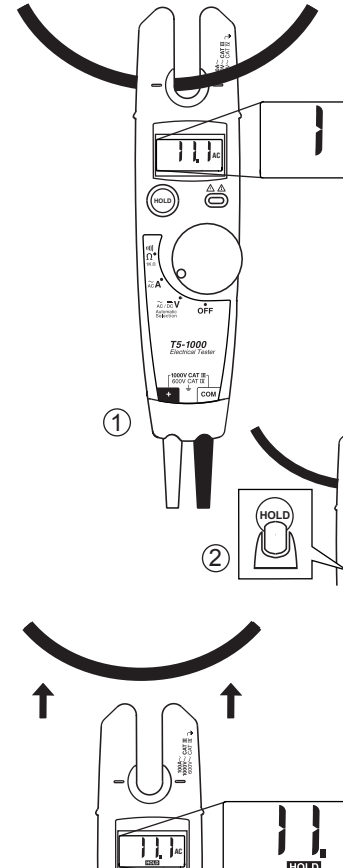

Auto Off

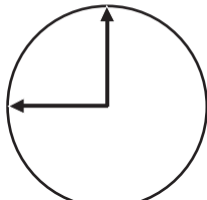

⚠ Warning

- **Disconnect test leads from power source before opening battery door.**
- **Débranchez les cordons d'essai avant d'ouvrir le couvercle de la pile.**
- **Prima di aprire lo sportello del vano della pila, scollegare i cavetti dal circuito di alimentazione.**
- **Die Prüfleiter vor dem Öffnen des Batteriefachs vom Stromnetz trennen.**

Specifications

Specifications subject to change without notice.

Calibration	1-year calibration cycle
Temperature Operating: Storage:	-10 °C to +50 °C (14 °F to 122 °F) -30 °C to +60 °C (-22 °F to +140 °F)
Altitude Operating: Storage:	2000 m (6562 ft) 10 000 m (32808 ft)

Function	T5-600 Range (600 V CAT III)	T5-1000 Range (1000 V CAT III)	Resolution
\tilde{V}	600 V rms	1000 V rms	1 V
\bar{V}	600 V	1000 V	1 V
\tilde{A}	100.0 A	100.0 A	0.1 A