

Top front connection for towel rail and baking tray pull-out

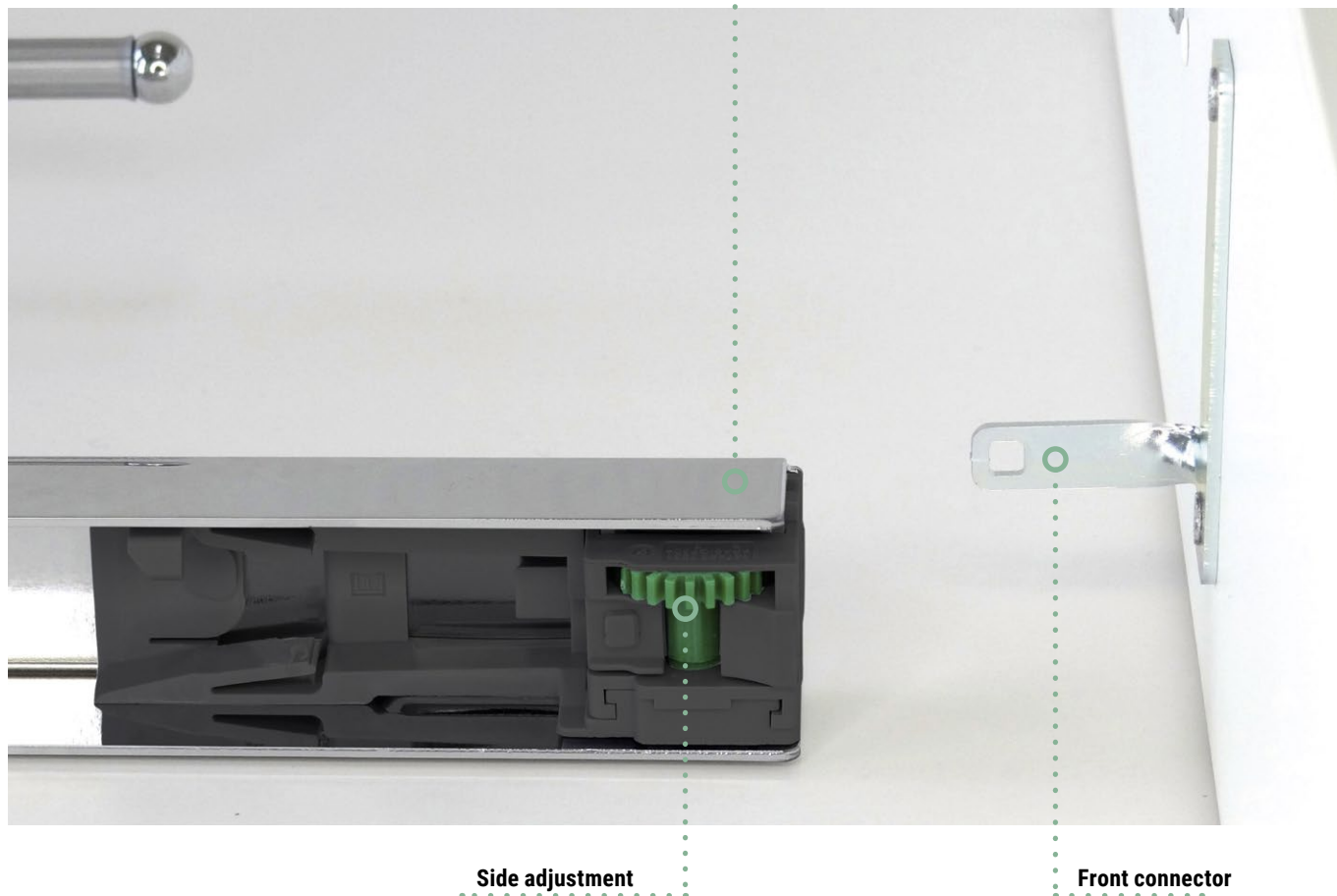

Side adjustment

Front connector

No.15

ULTRA-SLIM PULL-OUT WITH ClickFixx, NOW WITH 3D FRONT ADJUSTMENT

 KESSEBÖHMER

TWO INTERFACE OPTIONS FOR THE 3D-X NO.15 PULL-OUT MAKE FOR EASY INTEGRATION IN ANY PRODUCTION

PROCESS: the fitting can now either be clipped onto the runner without tools and connected using a front panel connector!

3D front adjustment makes adjustment ultra-simple.

PRODUCT FEATURES

- ClickFixx: clip-on connection for fitting and runner and fitting and front panel
- Toolless 3D front adjustment
- Can be installed with or without front panel
- SoftSTOPPlus with self-closing